

ZERO AXIAL BACKLASH.

LINEAR COUPLINGS

SERIES LK | 70 – 2,000 N



R+W[®]
COUPLING TECHNOLOGY

www.rwcouplings.com



MODEL LK

LINEAR COUPLINGS

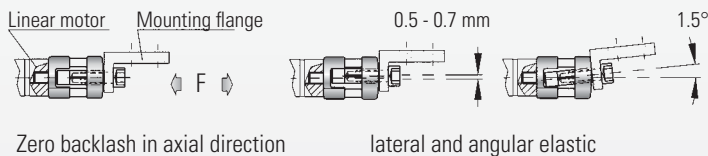
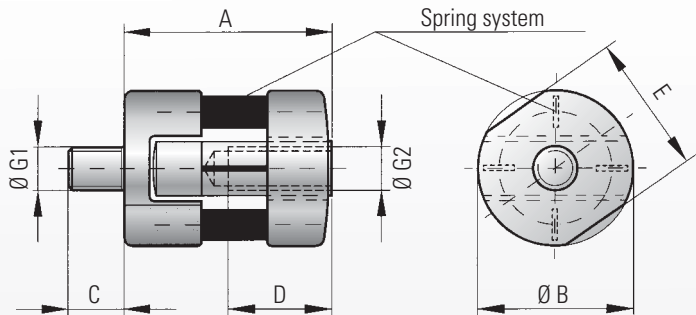

Ordering specifications

LK / 70 / XX

Model
Series/Nominal tensile force*
Special e.g. VA-Design

Model LK			Series					
			70	150	300	500	800	2000
Pressure force (N)	F		70	150	300	500	800	2000
Overall length (mm)	A		24	33	41.5	52	62	93
Outer diameter (mm)	B		18	22	30	42	50	72
Outer diameter of thread (mm)	G _{1/2}		M5	M6	M8	M10	M12	M16
Max. tightening torque thread (Nm)			4	7	18	30	60	170
Thread length (mm)	C		6.5	8	10	13	18	24
Thread length (mm)	D		10	12	16	20	24	32
Key width (mm)	E		16	20	27	38	46	60
Weight approx. (g)			11	23	57	135	236	580
Lateral restoring force (N)	max. values		10	18	48	96	122	180
lateral		(mm)	0.5	0.5	0.5	0.7	0.7	0.7
angular		(Degree)	1.5	1.5	1.5	1.5	1.5	1.5



Properties:

- Zero backlash in axial direction
- compensates angular misalignments up to 1.5° and lateral misalignments up to 0.7 mm (0,028 inch)
- low mass & weight = low inertia
- compact design
- designed for high tensile and compressive forces in highly dynamic applications

Material:

Coupling components are made of high-strength aluminium. Spring elements are made of special spring steel

Structure:

Input side: internal metric thread
Output side: external metric thread
The input - and output connection is effected by a backlash free spring system

Temperature range:

-30 to + 120° C (3.6 F to 270 F)

Backlash:

absolutely backlash-free

Brief overloads:

Acceptable up to 1.5 times the rated value

Service life:

These couplings have an infinite life and are maintenance free if operated within performance limits.

Special Design:

Custom bores, threads, and material available upon request.

Mounting Instructions

- Mounting: "Wrench flats" have been machined into the coupling hubs to aid in the mounting and dismounting of the coupling.
- **Caution: Do not exceed the tightening torque during mounting (see table)!**
- While mounting, ensure not to damage leaf-spring system
- **Maximum lateral and angular misalignment value must not be exceeded.**

The information mentioned in this document is based on our present knowledge and experiences and does not exclude the manufacturer's own substantial testing of the equipment. So this is no obligatory assurance even with regard to protection rights of Third Parties. The sale of our products is subject to our General Conditions of Sale and Delivery.

Special Designs

CYLINDRIC LINEAR COUPLINGS

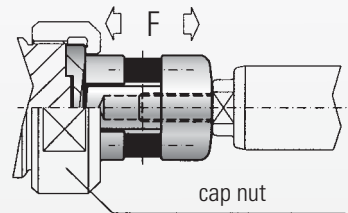
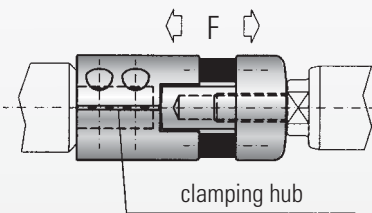
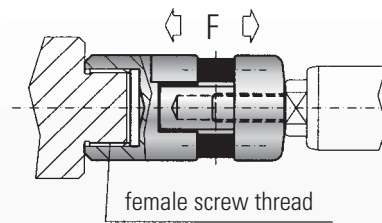
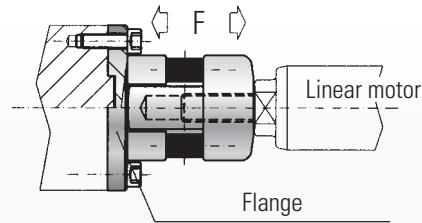

FLATENED LINEAR COUPLINGS

- Backlash free and space saving linear motor, or linear guidance connection

Tightening flange

Connection flange

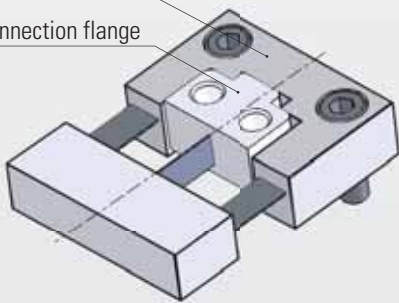

Top view

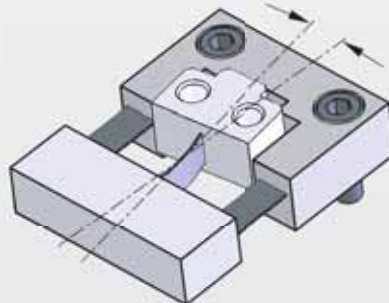

Angular misalignment

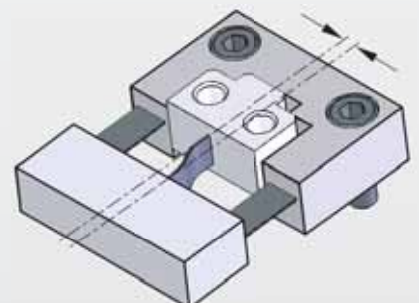

Lateral misalignment (sideways)

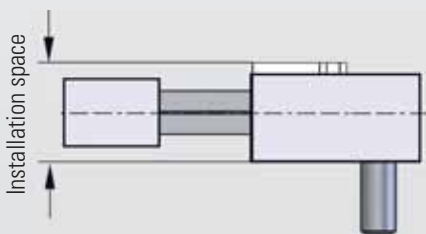

Side view

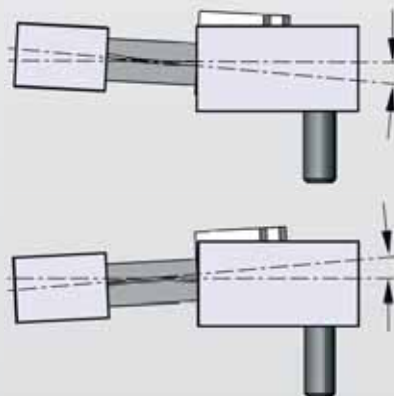

Angular misalignment (horizontal)

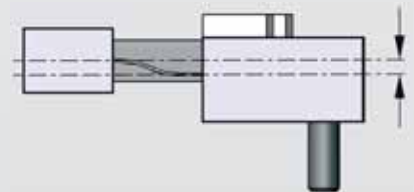

Lateral misalignment (horizontal)

**Experience and
Know-how
for your special
requirements.**

R+W Antriebselemente GmbH
Alexander-Wiegand-Straße 8
D-63911 Klingenberg/Germany

Tel. +49-(0)9372 – 9864-0
Fax +49-(0)9372 – 9864-20

info@rw-kupplungen.de
www.rwcouplings.com

**QUALITY
MANAGEMENT**

We are certified
according to ISO 9001-200



TGA-ZM-05-91-00
Registration No. 9605022

The information mentioned in this document is based on our present knowledge and experiences and does not exclude the manufacturer's own substantial testing of the equipment. So this is no obligatory assurance even with regard to protection rights of Third Parties. The sale of our products is subject to our General Conditions of Sale and Delivery.

THE R+W-PRODUCT RANGE



TORQUE LIMITERS Series SK

From 0,1 – 2.800 Nm, Bore diameters 4 – 100 mm
Available as a single position, multi-position, load holding, or full disengagement version
Single piece or press-fit design



BELLOWS COUPLINGS Series BK

From 15 – 10.000 Nm
Bore diameters 10 – 180 mm
Single piece or press-fit design



BELLOWS COUPLINGS ECONOMY CLASS Series BKC / BKL

From 2 – 500 Nm
Bore diameters 4 – 62 mm



LINE SHAFTS Series ZA/ZE

From 10 – 4.000 Nm
Bore diameters 10 – 100 mm
Available up to 6 mtr. length



MINIATURE BELLOWS COUPLINGS Series MK

From 0,05 – 10 Nm
Bore diameters 1 – 28 mm
Single piece or press-fit design



SERVOMAX[®] ELASTOMER COUPLINGS Series EK

From 2 – 2.000 Nm
Shaft diameters 5 – 80 mm
backlash-free, press-fit design



LINEAR COUPLINGS Series LK

From 70 – 2.000 N
Thread M5 – M16



POLYAMID COUPLINGS MICROFLEX Series FK 1

Rated torque 1 Ncm
Bore diameters 1 – 1,5 mm